

HOW TO RESET THE WASTE MAINTENANCE TANK OF THE EPSON 4000 PRINTER

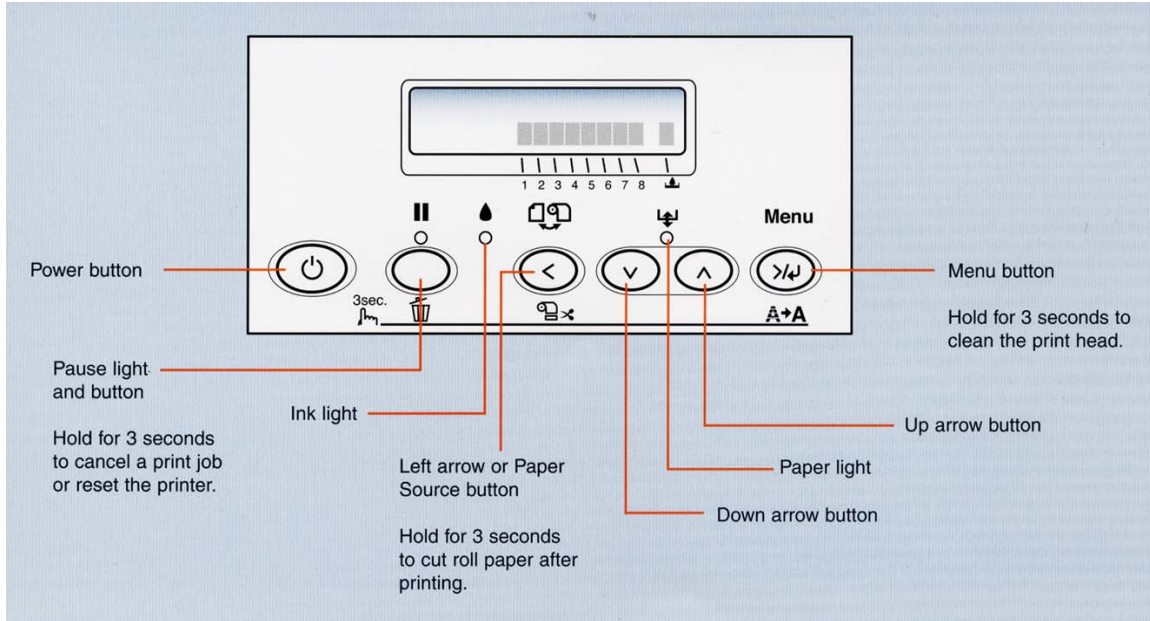

1. POWER OFF
2. DEPRESS THE PAPER SOURCE, DOWN ARROW AND UP ARROW, HOLD WHILE DEPRESSING THE POWER BUTTON. Release the power button, then release all three buttons.
3. *SELF TESTING* WILL BE DISPLAYED. PRESS THE DOWN ARROW BUTTON UNTIL *CLEAR COUNTERS* IS DISPLAYED. PRESS THE MENU BUTTON 1 X, THEN
4. PRESS DOWN ARROW 10X UNTIL YOU SEE *MAINT EXEC*. PRESS THE MENU BUTTON 1 X, WAIT FOR THE RESET. RED LIGHTS WILL COM ON. THEN POWER OFF.

WHEN YOU TURN YOUR PRINTER BACK ON THE MAINTANENNCE TANK WILL SHOW EMPTY.

REV091404